

OPBH10N Series

High Level Order Picker • AC Power • 1.0 tonne

OPBH10N
OPBH10NH

Unbeatable at heights... and ergonomically supreme

The OPBH order picker series offers unprecedented levels of efficiency in the use of warehouse space. With an ability to pick at heights from 4.7 m to an amazing 11.5 m – the highest in the market – and to operate in the narrowest of aisles, not a single cubic

metre will be wasted! What's more, the unique design of these trucks will allow your operator to work comfortably and pick quickly from the safe environment of the cabin.

Both models feature the revolutionary Visionmast, with its remarkably clear views and high residual capacities. The innovative Active Sway Control (ASC), fitted as standard for masts with lifting heights of 5.1m or more, reduces delays due to mast sway by 50% in typical applications.

Choose the high performance 48V OPBH10NH model and you will get AC powered hydraulics as well as drive –

generating the highest lift speed in the market. But both this model and the 24V OPBH10N are equipped with every possible aid to the operator. Suitable for rail guided, wire guided or non-guided applications, each comes with a choice of specifications to meet particular needs – including different chassis and cabin widths, battery capacities, control layouts and rail guide heights.

Frame and body

- **Choice of 3 chassis widths and 4 cabin widths** allows adaptation to different applications.
- **Low centre of gravity and double load wheels** result in high stability and reduced step height.
- **Innovative design** combines attractive styling with superb ergonomics.

Mast and fork assembly

- **Triplex mast** can be chosen for applications requiring restriction in overall lowered height.
- **Revolutionary Visionmast** offers unrivalled forward vision when travelling with forks trailing – and high residual capacities.
- **Innovative Active Sway Control (ASC)** specified as standard for platform heights of 5100 mm or greater minimises mast sway, reducing related delays by 50%.



OPBH10N Series

High Level Order Picker

AC Power • 1.0 tonne

Characteristics				
1.1	Manufacturer (abbreviation)		Mitsubishi	Mitsubishi
1.2	Manufacturer's model designation		OPBH10N	OPBH10NH
1.3	Power source: (battery, diesel, LP gas, petrol)		Battery	Battery
1.4	Operator type: pedestrian, (operator)-standing, -seated		Stand-on	Stand-on
1.5	Load capacity	Q kg	1000	1000
1.6	Load center distance	c (mm)	400/600	400/600
1.8	Load wheel axle to fork face (forks lowered)	x (mm)	210	210/350
1.9	Wheelbase	y (mm)	1490	1490/1525
Weight				
2.1	Truck weight with maximum battery weight	kg	3400*	4200*
2.2	Axle loadings with nominal load & maximum battery weight, drive/load side	kg	1050/3350*	1360/3840*
2.3	Axle loadings without load & with maximum battery weight, drive/load side	kg	1450/1950*	2070/2130*
Wheels, Drive Train				
3.1	Tyres: PT=Power Thane, Vul=Vulkollan, drive/load side		Vul/Vul	Vul/Vul
3.2	Tyre dimensions, drive side	(mm)	360x140	360x140
3.3	Tyre dimensions, load side	(mm)	150x100	150x100
3.5	Number of wheels, drive/load side (x=driven)		1x / 4	1x / 4
3.6	Track width (center of tyres), drive side	b10 (mm)	867 - 1270	867 - 1270
Dimensions				
4.2	Height with mast lowered (see tables)	h1 (mm)	See tables	See tables
4.4	Lift height (see tables)	h3 (mm)	See tables	See tables
4.5	Overall height with mast raised	h4 (mm)	See tables	See tables
4.7	Height to top of overhead guard	h6 (mm)	2260	2260
4.10	Height of load legs	h8 (mm)	151	151
4.11	Supplementary lift	h9 (mm)	750	750
4.14	Platform height, raised	h12 (mm)	See tables	See tables
4.15	Fork height, fully lowered	h13 (mm)	85	85
4.19	Overall length	l1 (mm)	3250	3250
4.20	Length to fork face (includes fork thickness)	l2 (mm)	2095	2095
4.21	Overall width	b1 / b2 (mm)	1016/1000-1590	1016/1000-1590
4.22	Fork dimensions (thickness, width, length)	s / e / l (mm)	40/120/1150	40/120/1150
4.25	Outside width over forks (minimum/maximum)	b5 (mm)	540	540
4.27	Width over guide rollers (min.)		1260	1260
4.32	Ground clearance at center of wheelbase, (forks lowered)	m2 (mm)	45	45
4.33a	Working aisle width (Ast) with 1000 x1200 mm pallets, load crosswise	Ast (mm)	1400	1400
4.34a	Working aisle width (Ast) with 800 x1200 mm pallets, load lengthwise	Ast (mm)	1300	1300
4.35	Turning circle radius	Wa (mm)	1705	1705, 1745
4.41	Transfer aisle width (pallet 1000 x 1200 mm lengthwise & 200mm clearance)	l8 (mm)	See tables	See tables
Performance				
5.1	Travel speed, with/without load	km/h	9.0 / 9.0	9.0 / 9.0
5.2	Lifting speed, with/without load	m/s	0.20 / 0.30	0.35 / 0.40
5.3	Lowering speed, with/without load	m/s	0.40 / 0.45	0.40 / 0.45
5.10	Service brakes (mechanical/hydraulic/electric/pneumatic)		Electric	Electric
Electric motors				
6.1	Drive motor capacity (60 min. short duty)	kW	3.5	3.5
6.2	Lift motor output at 15% duty factor	kW	5.0	8.5
6.4	Battery voltage/capacity at 5-hour discharge	V/Ah	24 / 775	48 / 465, 775
6.5	Battery weight	kg	591	746, 1119
Miscellaneous				
8.1	Type of drive control		Stepless	Stepless

Continuing improvement may lead to changes in these specifications.

* Platform height 6,100 mm



Clear-view Visionmast



Easy-reach cabin design



Smooth lightweight gates



User-friendly joystick control

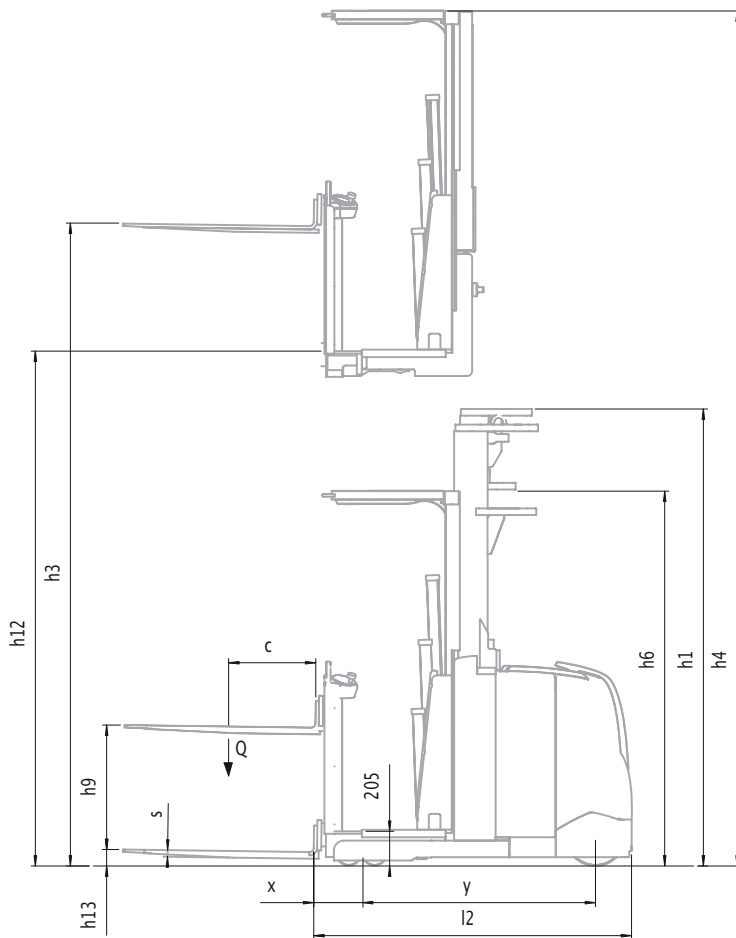

		OPBH10N				
Mast type		h12	h1	h4	h3	h12 +1500
		mm	mm	mm	mm	mm
Duplex	3200	2237	5250	3830	4700	
	3500	2417	5550	4130	5000	
	4200	2757	6250	4830	5700	
	4800	3032	6850	5430	6300	
	5200	3237	7250	5830	6700	
	6200	3737	8250	6830	7700	
Triplex	4100	2237	6150	4730	5600	
	4600	2237	6650	5230	6100	
	5100	2417	7150	5730	6600	
	6100	2757	8150	6730	7600	
	7000	3032	9050	7630	8500	
	7700	3437	9750	8330	9200	
	8100	3577	10150	8730	9600	
	8100	3577	10150	8730	9600	

		OPBH10NH				
Mast type		h12	h1	h4	h3	h12 +1500
		mm	mm	mm	mm	mm
Duplex	3200	2237	5250	3830	4700	
	3500	2417	5550	4130	5000	
	4200	2757	6250	4830	5700	
	4800	3032	6850	5430	6300	
	5200	3237	7250	5830	6700	
	6200	3737	8250	6830	7700	
Triplex	4100	2237	6150	4730	5600	
	4600	2237	6650	5230	6100	
	5100	2417	7150	5730	6600	
	6100	2757	8150	6730	7600	
	7000	3032	9050	7630	8500	
	7700	3437	9750	8330	9200	
	8100	3577	10150	8730	9600	
	8600	3737	10650	9230	10100	
	9300	3997	11350	9930	10800	
	10000	4207	12050	10630	11500	

		Minimum transfer aisle width*		
Mast type		OPBH10N 775 Ah	OPBH10NH 465 Ah	OPBH10NH 775 Ah
	1200 x 1000 cross wise		3256	3256
1200 x 800 length wise		3371	3371	3546
1200 x 800 cross wise		3145	3145	3322

* Including 200 mm clearance and 1000 mm or 1150 mm forks

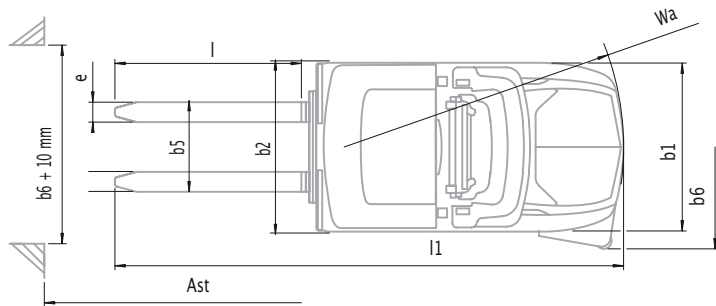

- Ast = Working aisle width
- Ast3 = Working aisle width (b12 ≤ 1000 mm)
- Ast = $Wa + \sqrt{(l6 + x)^2 + (b12 / 2)^2} + a$
- Ast3 = $Wa + l6 + a + x$
- Wa = Turning radius
- l6 = Pallet length
- x = Load wheel axle to fork face
- b12 = Pallet width
- a = Safety clearance = 2 x 100 mm

Active Sway Control (ASC)

Featuring intelligent pressure sensors and special Mitsubishi software, ASC counteracts the sway that occurs when braking or accelerating while working at heights. Swaying distance can be reduced by up to 85% - improving productivity by 6% in typical applications.





Clear display



View-through floor



Lightweight battery cover

Drive

- **Powerful AC motor** on both models provides high performance and smooth, quiet, controlled, efficient operation – while lowering service costs.

Steering system

- **Small turning circle** means manoeuvrability is exceptional and transfer aisle can be very narrow.

Brakes

- **Regenerative braking** ensures effective control, reduced brake wear and longer shift life.
- **Optional end of aisle braking** restricts speed at which truck leaves aisles – to minimise risk of accidents.

Hydraulics

- **Powerful AC hydraulic motor** on OPBH10NH provides smooth, controlled, rapid lifting – the fastest in the market.

Electrical and control systems

- **High capacity batteries** offer ratings up to 775 Ah for long shifts.
- **Battery rollers** make lateral exchanges quick, easy and safe.
- **Wire or rail guidance** is available for very narrow aisle applications – with choice of 40 mm or 100 mm high rail set-up.
- **New generation control system** with PIN code starter pad sets performance parameters to suit load, application and driver perfectly.
- **Lightweight battery cover** gives excellent access for maintenance.
- **On-board diagnostics** allow fast, easy fault finding through the LCD display's service menu.

Operator environment and controls

- **Active Sway Control (ASC)** technology increases operator's productivity, safety and comfort.
- **Unique ergolift design** with lifting mechanism below cabin floor results in thinner cabin wall which – together with pallet lift (up to 750 cm) – makes load easier to reach.
- **Unique side gates** are comfortable to lean against (due to smooth shape) and easy to open (due to lightweight aluminium construction).
- **Split control unit design** further enhances access to load and reduces risk of accidental operation of controls while leaning outwards.
- **Ergonomic controls** include joystick and inductive hand detector (allowing operation only if both hands are within cabin) for safe, precise operation within the aisle.
- **Location of controls** can be fork side or mast side, according to choice, to suit application.
- **Clear, informative LCD display** alerts operators and service engineers to potential problems – helping to avoid damage, improve efficiency and encourage maintenance.
- **Openings in cabin floor** give clear view of load legs.

- **Non-slip floor mat** is specially designed in relation to operator's orientation in each part of the cabin, to maximise grip.

- **Comfort features** include Active Sway Control, height-adjustable backrest, low step height (205 mm) and ergonomically shaped cabin.

Other features

- **Rapid access features** together with long service interval, proven component reliability, quick fault finding and AC technology ensure low operating costs.

Options

- **Rail or wire guidance**
- **Automatic braking at aisle end**
- **Customer name/logo/artwork on side panels**
- **Key switch instead of PIN code**
- **Working lights and cabin lights**
- **Wide variety of fork dimensions**
- **Lift stop with override function**
- **Auto stop for obstacles in aisle**
- **Active Sway Control (platform heights < 5100mm)**
- **Cold store modification (Class III, -35° C)**
- **Order picking cage (max duplex mast 4200 mm)**



OPBH10N

when reliability is everything...

Like any product bearing the Mitsubishi name, our materials handling equipment benefits from the huge resources and cutting-edge technology of one of the world's largest corporations. So when we promise you **quality, reliability and value for money**, you know it's a guarantee we have the power to deliver.

Every model in our comprehensive, award-winning range of forklift trucks and warehouse equipment is built to a high specification and is designed to keep on working for you... day after day... year after year... whatever the job... whatever the conditions.

To ensure your truck stays in constant productive action, we have a network of local dealers – hand-picked for their commitment to customer care... and backed up by the Mitsubishi Forklift Trucks organisation. No matter where you are, we have a dealer close by – ready and willing to meet your needs.

That friendly local service covers everything from identifying the perfect model and configuration for your application to providing competitive, flexible finance and maintenance packages, unbeatable warranties, long and short term hire, and highly responsive field service and repairs... as well as the industry's quickest and most reliable parts supply.

Only Mitsubishi can give you this combination of global engineering excellence and outstanding local support... only Mitsubishi offers you such a quality product at such an affordable price... and only Mitsubishi places reliability as high as you do in its priorities. Contact your local dealer now and see what Mitsubishi can do for you.

You can find your nearest dealer at www.mitforklift.com



WESM1346 (12/10) ok
© 2010 MCFE
Printed in The Netherlands

mitforklift@mcf.nl www.mitforklift.com

NOTE: Performance specifications may vary depending on standard manufacturing tolerances, vehicle condition, types of tyres, floor or surface conditions, applications or operating environment. Trucks may be shown with non-standard options. Specific performance requirements and locally available configurations should be discussed with your distributor of Mitsubishi forklift trucks. Mitsubishi follows a policy of continual product improvement. For this reason, some materials, options and specifications could change without notice.